



ADA Compliant

MULTI-RESIDENTIAL PROJECTS

ADA COMPLIANCE

HomeCo Kitchen & Bath understand the importance of ADA regulations during the installation of our kitchen and bathroom products. We want our customers to be comfortable and confident that HomeCo will strive to deliver every job with all necessary ADA requirements complied. We also appreciate any feedbacks and requests on ADA requirements that is not listed here.

KITCHEN:



A. Sink base cabinet is 36" wide with removable bottom panel, doors, drawer face and toe kick. Inside width will be no less than 30"

B. Bottom of the sink to floor will have a minimum height of 27". Floor to front of cabinet will have a minimum of 29".

C. A minimum of 30" countertop workspace with removable cabinet doors, drawers, toe kick for wheelchair accessibility.



In the event that kitchen counter space does not have 30" or more. Two breadboards that adds up to 30" (15" and 15") will be provided and installed in to the cabinets.



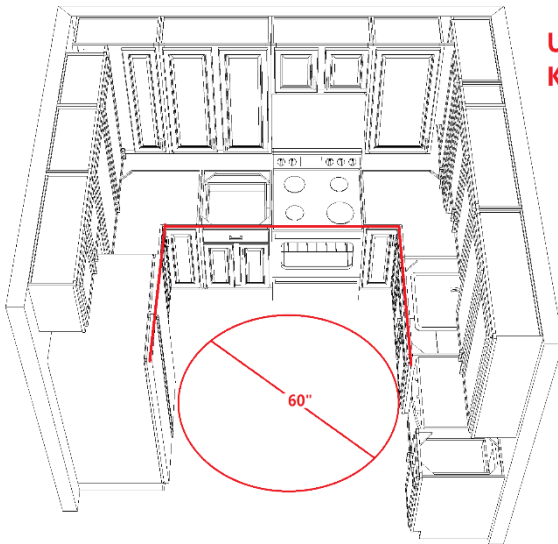

**U-SHAPE
KITCHEN**

-When designing kitchen shop drawings, HomeCo will make sure that the kitchen space will have minimum 60" radius for U-Shape kitchen to allow wheelchair accessibility.

-If 60" radius is not met in the kitchen space, a "galley kitchen" design will be offered.

-"Galley kitchen" only requires a space no less than 48".

-When the kitchen cabinets is next to a entry door, if the door swings towards to the kitchen, HomeCo will make sure to leave no less than 18" of space between the entry door and the first cabinet.

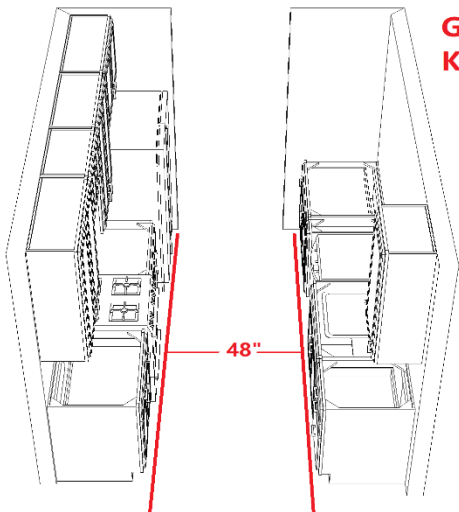

**GALLEY
KITCHEN**

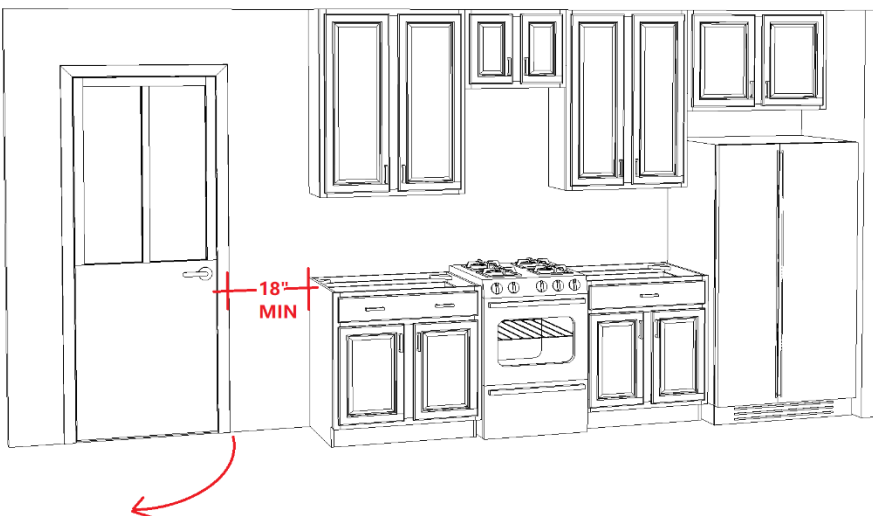

BATHROOM

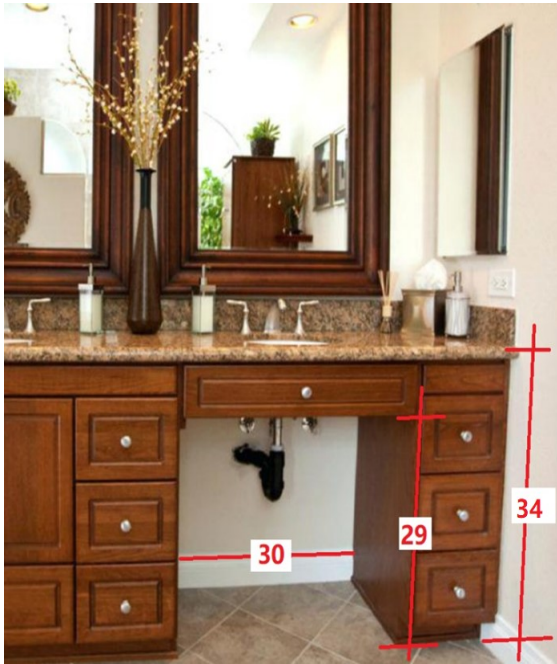

1. Bathroom cabinet and counter height shall not exceed 32" from the floor.
2. Wheelchair accessible should have a minimum of 29".
3. Sink cabinet inside width shall be no less than 30". HomeCo usually uses 33" or 36" vanity sink cabinet to comply with 30" inside space.
4. HomeCo vanity sink cabinet will have removable doors, drawer, bottom panel and toe kick

Other Remarks:

1. HomeCo understand that each unit must have one ADA accessible bathroom, the bathroom must have a 60" radius of empty space for wheelchair operation. HomeCo will install ADA cabinet in bathrooms that meets such criteria unless customer have other request.
2. When installing bathroom vanity cabinets. If there is a toilet next to the cabinet, HomeCo will make sure that the finished cabinet will have a minimum of 18" space between the cabinet and the center of the toilet drain.
3. Bathroom sink must be 18" min from the wall to the center of the sink.

